

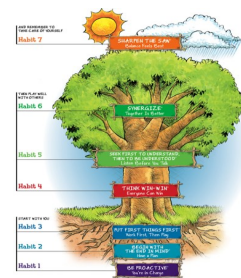

HOOT, HOOT, HOOT, HOORAY!

Enders Leaders Pave the Way!

October 2023



Happy October Enders Families!

The weather is getting ready to cool down and fall is definitely in the air! Our Enders Family has a lot of FUN in store this October. Please check out the list of events we have scheduled for our Enders Leaders! Make sure to keep our newsletter handy as well as check out our Social Media pages to stay on top of the latest and greatest activities we have in store for our students AND families! We look forward to seeing all of your conferences this month!

Yours in Learning,

Mrs. Audrey Miller

Important Information in Newsletter:

- Leader In Me – October Experiences!
- October Calendar & PTO Magnet (with calendar/events QR Code)
- Arrival/Dismissal Information & Maps w/friendly reminders–Thank you for your help!

Upcoming Events:

- ☆ Oct. 2nd-31st–Ronald McDonald Pop Tab Collections
- ☆ Oct. 3rd–Fall Picture Day!
- ☆ Oct. 4th–Red-Wheel Fundraiser Kick-Off
- ☆ Oct. 10th & 11th–CONFERENCES 4:30-7:50
- ☆ Oct. 12th–NO SCHOOL & CONFERENCES 9:00-4:00
- ☆ Oct. 13th–NO SCHOOL, Non-Teaching Duty Day
- ☆ Oct. 16th-27th–PTO Candy Contest
- ☆ Oct. 19th–Roller City Skate Night 6-8
- ☆ Oct. 23rd – Virtual PTO Meeting @ 7pm
- ☆ Oct. 26th–Red-Wheel Orders & Money Due
- ☆ Oct. 27th–PTO Trunk or Treat 6:00-7:00
- ☆ Oct. 31st–Classroom Fall Parties



HOOT, HOOT, HOOT, HOORAY!

Enders Leaders Pave the Way with Leader In Me!

The Leader in Me™



Habit 2: Begin with the End in Mind

Begin with the End in Mind means to think about how you would like something to turn out before you get started.

Reading a recipe before cooking or looking at a map before leaving on a trip is beginning with the end in mind.

For young children, a good example is that of a jigsaw puzzle. Before doing a puzzle, they look at the cover of the box. They start with the end in mind.

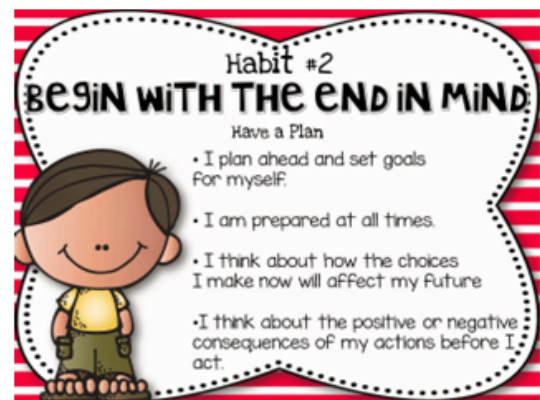

Havina a Plan



Habit two focuses on how it is important to have a plan. I plan ahead and set goals. I do things that have meaning and make a difference. I am an important part of my classroom and contribute to my school's mission and vision. I look for ways to be a good citizen.

Family Mission Statement

An important part of Habit two is to have a mission statement in which you identify what values are important to you and how you can help foster them in your personal or family life. Select some values that your family finds to be the most important and come up with a statement that reflects how you will help grow these values as a family unit.

A GOAL
without
A PLAN
is just a
WISH

Creating a WIG

A Wildly Important Goal, or a "WIG" is one of the most important aspects of habit two. A goal that you set for yourself must be something that is important to you. It also needs to be something that you can track daily, weekly, or monthly. Create an exciting scoreboard to help with your tracking, and have an accountability partner that will help you stay on track by checking in with your progress and often.

WHAT DO YOU VALUE? CIRCLE THREE.

HONESTY	CLEANLINESS	CREATIVITY
RESPECT	BEING ON TIME	CELEBRATING
HARD WORK	INTEGRITY	PEOPLE'S STRENGTHS
FAIRNESS	CARING	GOOD MANNERS
FUN	LEARNING	OTHER IDEAS?
TEAMWORK	NO BULLYING	_____
LOYALTY	SHARING	_____
SERVICE	HELPING OTHERS	_____

Stay
connected
with our
Enders
Family!



STAY INFORMED!

Scan to
find the
23-24
Enders
Calendar!



SCHOOL HOURS & ATTENDANCE



8:50 a.m. - 4:10 p.m.
(316)-973-6751

Principal Audrey Miller
amiller@usd259.net

SCHOOL BREAKS



Fall Break
November 22nd-24th

Winter Break
Dec. 18th - Jan. 2nd

Spring Break
March 11th-15th

CONFERENCES Oct. 10th-12th
Feb. 7th-9th

ENDERS LEADERSHIP & COMMUNITY SERVICE MAGNET



October 2023

Habit of the Month: Begin with the End in Mind

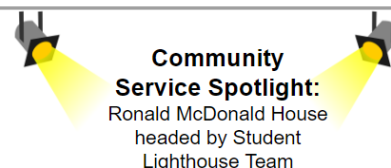

Sunday	Monday	Tuesday	Wednesday	Thursday	Friday	Saturday
1	2 Ronald McDonald's Pop Tab Collections Begin	3 Yearbook Picture Day -See schedule on Drive 	4 <u>Leader in Me Day</u> P.T.O. Red Wheel Kickoff 3:00	5	6	7
8	9	10 P/T Conferences 4:30-7:50	11 P/T Conferences 4:30-7:50	12 <u>No School for Students</u> P/T Conferences 9:00-4:30	13 <u>No School</u> End of 1st Qtr. Non-Teaching Duty Day	14
15	16 3rd & 5th Vision Screenings PTO Candy Contest Begins	17	18	19 Roller City Skate Night 6:00-8:00 	20	21
22 P.T.O. Meeting via Teams 7:00 pm Hearing Screenings Pre-K, K, 2nd, 5th	23	24	25	26 Red Wheel Money/Orders DUE	27 Trunk or Treat 6:00-7:00 PTO Candy Contest Ends	28
29	30	31 Fall Parties 3:30-4:00 Ronald McDonald's Pop Tab Collections Ends				

ARRIVAL & DISMISSAL PROCEDURES

The Parent Pick-up Lane

If you are picking up your student, please remain in your car and follow the pick-up lane (see map) to ensure a safe and quick arrival and departure. Staff will be out front to help escort your child to your vehicle when you approach one of the stations. Please listen to staff and follow their directives.

THERE IS NO PARKING ALONG OSAGE OR ALONG 29TH STREET. IF YOU PARK HERE YOU MAY BE ASKED TO MOVE YOUR VEHICLE.

Please refrain from parking in our neighbor's parking lots or driveways out of respect for those that live there.

Student Walkers

Crossing guards will be at the corners of Osage and 29th before the dismissal bell to assist with crossing the intersection safely. If you are picking up and walking with your student, please attempt to use the crosswalks that the city has in place in order to keep our parent pick-up lane moving and to ensure your child learns safe ways of crossing the street. You may pick up your child at the front of the building and a staff member will release them to you.



Bike Riders

If your student is riding to and from school, we do have a bike rack available for students to secure their bike with. The school is not responsible for lost and/or stolen property.



EARLY DISMISSAL

Students will be released to only Emergency Contacts who are listed on ParentVue. We encourage parents to attempt to make appointments on days school is not in session or before or after school when possible. The parent must check out the child through the office. The student will be called by office personnel to the office to meet their parent.

2023-2024 Arrival Procedure

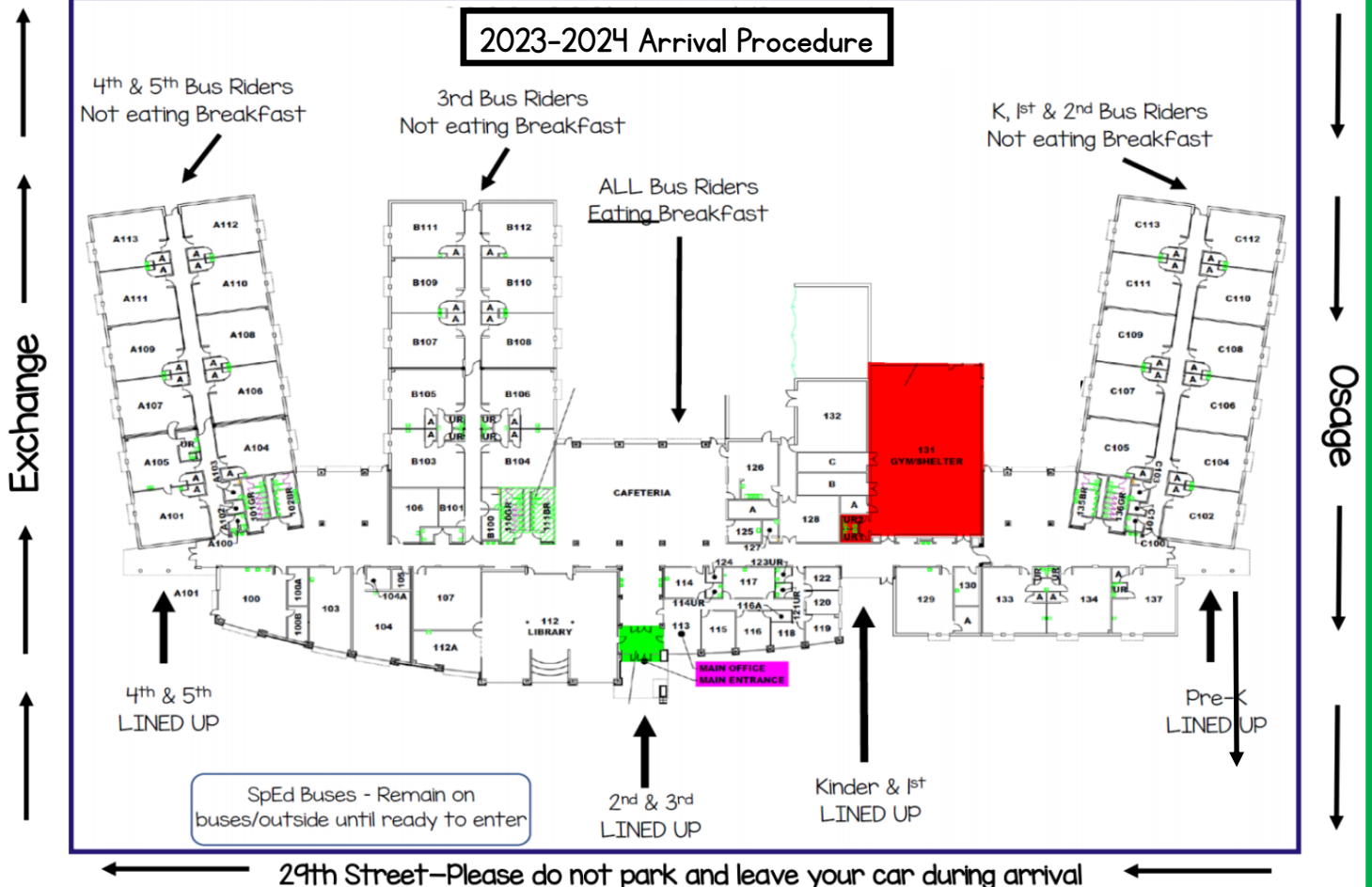

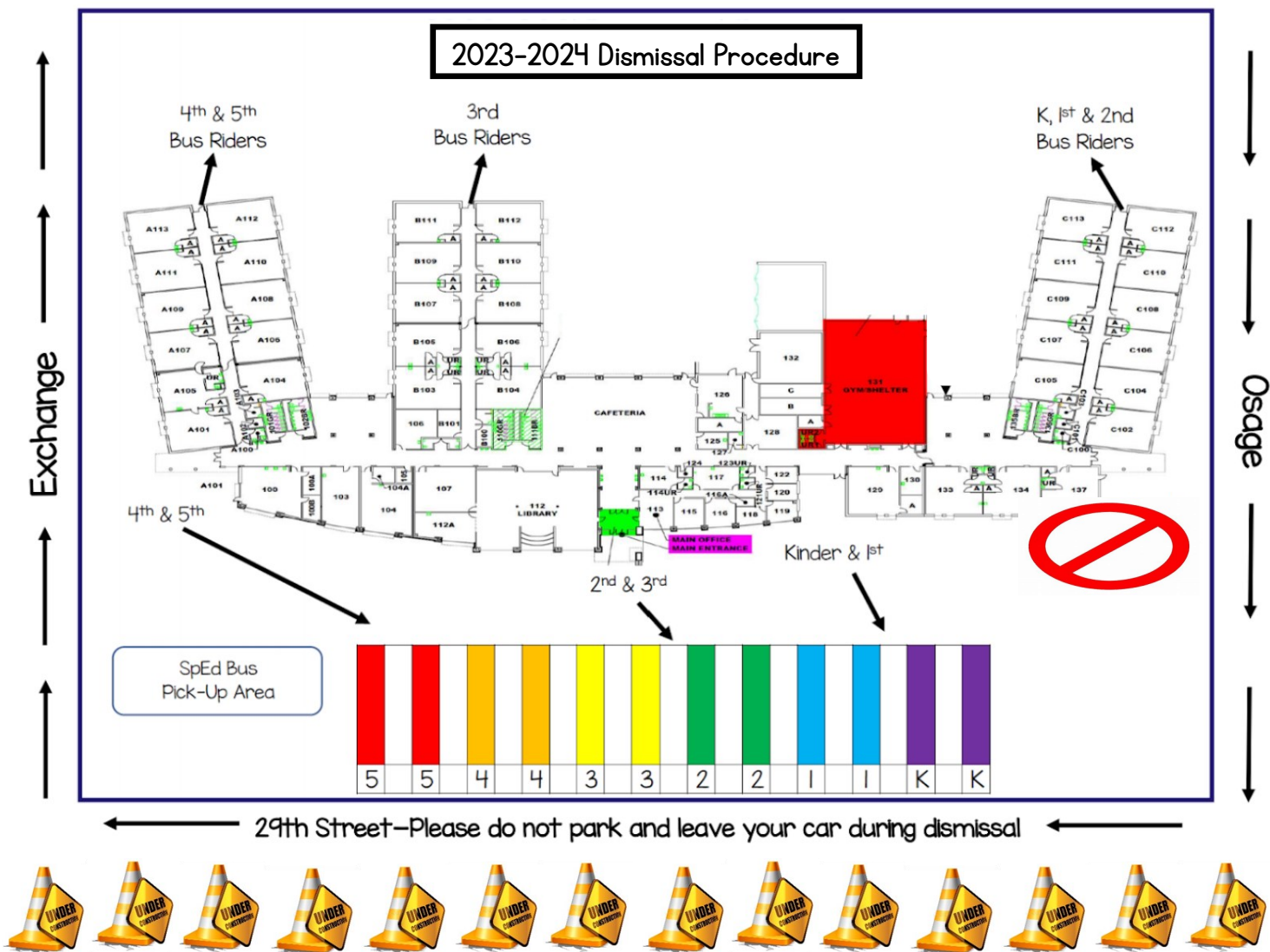

PICK-UP PROCEDURES—Important Information:

Last year, our team reevaluated our Pick-Up Procedures in order to address safety concerns. These procedures went into effect last year and after experiencing success and fewer incidents, will be carried over.

West Parking Lot entrance will be CLOSED OFF beginning at 4:00 and will not reopen until after pick-up at 4:20. It is a right turn only out of the West Lot for arriving SpEd buses. Please remain in your vehicles and follow our pick-up line to pick up your children. As always NO PARKING on Osage or 29th street.



We appreciate your support and I know our adults will be good examples of patience and kindness as we implement our procedures.